

HIGH VISCOSITY FILTER STAND



**Shown with wheel kit option*

Powerful & Smart

Our High Viscosity Filter Stand is an excellent choice for “offline” filtration of hydraulic and gear lubricants. Robust & high capacity filters allow for filtering of viscosities up to ISO 680 (7500 ssu). This system is completely customizable to fit all your needs.

Typical Applications:

- Filtering contaminated systems
- High viscosity filter or transfer
- Pre-filtering new oil
- Permanent filtration: tanks, reservoirs, or sumps
- Dispensing new oils
- Large volumes of fluids

ForFluids.com

HIGH VISCOSITY FILTER STAND

Don't see the options you need?
Contact For Fluids at 1(630) 922-5020
for more information.

Performance:

For filtering mineral and synthetic based oils (hydraulic oils, gear oils and turbine oils) with a maximum operating viscosity range of ISO VG 680 (7500 ssu) at 100°F within ambient temperature ranges of -15°F to 250°F.

Standard Features:

Frame:	Carbon steel housing; powder coated frame; caster wheels with brakes
Paint:	Multiple color options available
Motor:	1HP, 115vac, 60Hz or Pneumatic (other voltage options available)
Filter:	18" or 36" synthetic micro-glass; various micron level filters available
Pump:	Heavy duty, cast steel gear pump. Available in 1, 2, 5 and 10 GPM (other pump flows available)
Connections:	Hydraulic high pressure available w/ various quick connect options
Power Switch:	Premium on/off reset motor starter or sealed on/off switch
Cord Reel:	40ft. retractable electric cord reel (110 VAC options only) (various corded lengths available)
Filter Indicators:	Standard color-coded differential pressure indicator
Pump Relief:	Opens at 150psi (standard pump)
Weight:	Approx. 195lbs (will vary depending on options)
Dimensions:	Approx. 26"L x 23"W x 55"H
Options:	<ul style="list-style-type: none">• Available with Single or Dual Housings• Available with or without Wheel Kit for stationary or mobile applications

Components:

Item Number	Description	Qty.
1	Lid	1
2	Differential Pressure Indicator	1
3	Handle	1
4	Sealed On/Off Switch	1
5	Motor	1
6	Pump	1
7	Wheel Kit (Optional)	2
8	Caster Wheel w/ Brakes	2
9	Drain	1
10	Hydraulic Hose	1
11	Filter Housing	1
12	Cord Reel	1

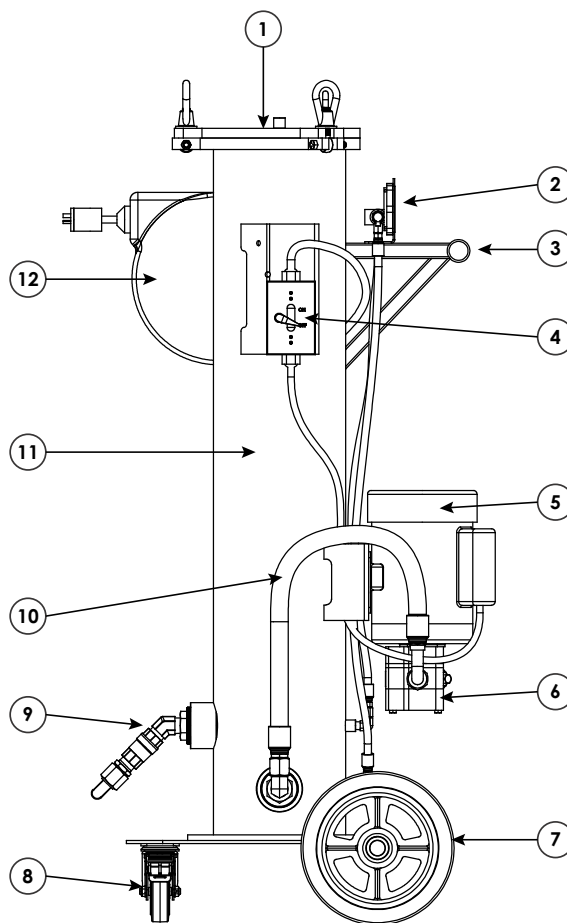

ForFluids.com